

**Map 2: Features, Issues and Challenges**

Author: Robin Fuller  
Scale @ A3: 1:10,000  
Date: 24/02/2023

**Legend**

- Plan Area
- Car Park**
- P Formal
- P Informal
- Forest Roads
- Inland River
- Watercourses
- Formal trail
- Mountain bike loop
- Cycle path
- Quarries
- Deep peat
- Mature woodland
- Native wet woodland

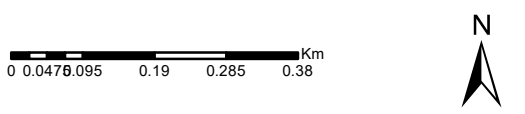

Reproduced by permission of Ordnance Survey on behalf of HMSO.  
© Crown copyright and database right [2023]. All rights reserved.  
Ordnance Survey Licence number [100021242].  
© Getmapping Plc and Bluesky International Limited 2023.

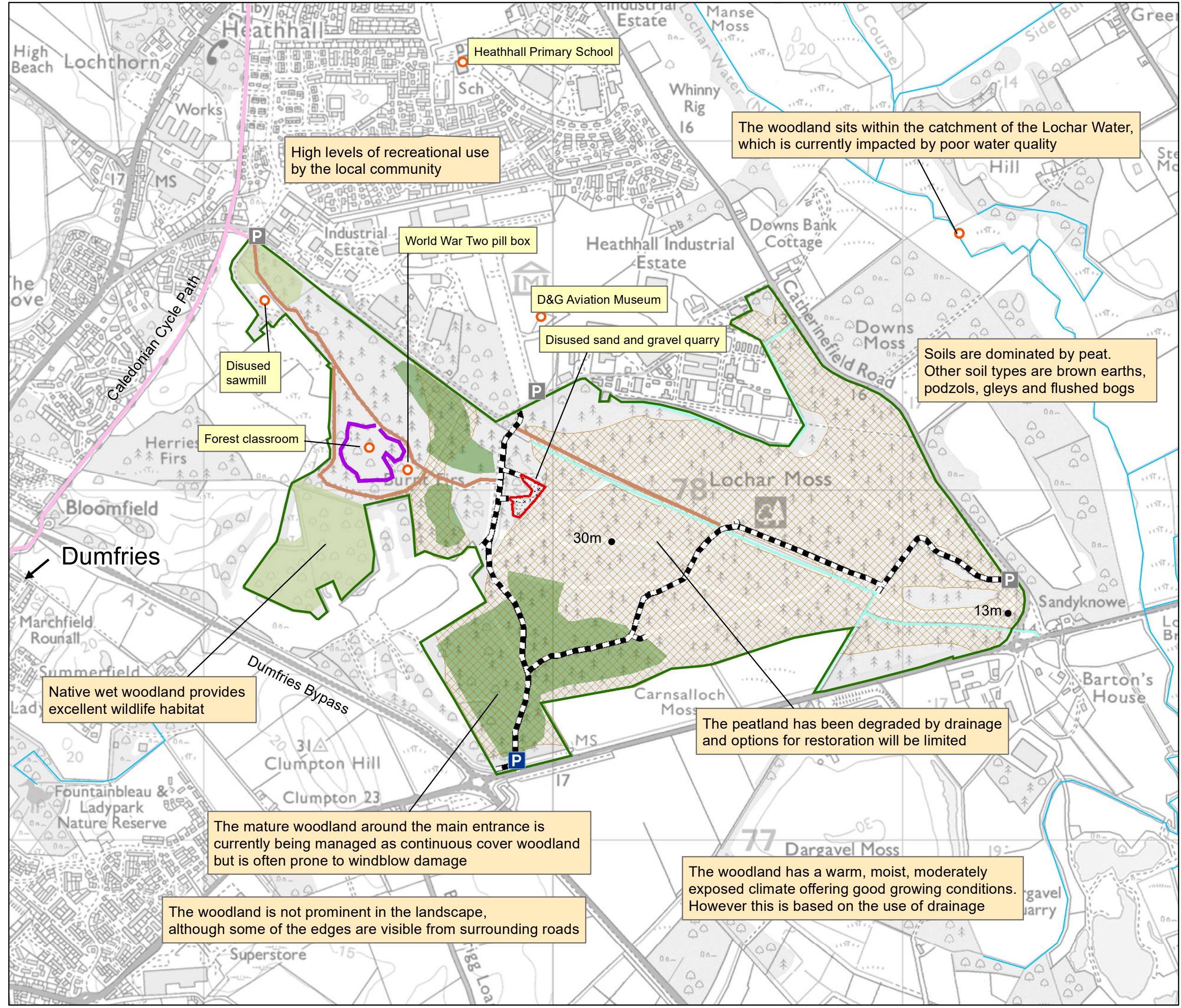

High levels of recreational use by the local community

The woodland sits within the catchment of the Lochar Water, which is currently impacted by poor water quality

World War Two pill box

D&G Aviation Museum

Disused sand and gravel quarry

Soils are dominated by peat. Other soil types are brown earths, podzols, gleys and flushed bogs

Disused sawmill

Forest classroom

Native wet woodland provides excellent wildlife habitat

The peatland has been degraded by drainage and options for restoration will be limited

The mature woodland around the main entrance is currently being managed as continuous cover woodland but is often prone to windblow damage

The woodland is not prominent in the landscape, although some of the edges are visible from surrounding roads

The woodland has a warm, moist, moderately exposed climate offering good growing conditions. However this is based on the use of drainage