



Map 5 -Issues & Opportunities2

Author: Eelco De Jong

Scale @ A3: 1:7,500

Date: 27/09/2024

Legend

- Watercourses**
 - Watercourses
- Core Paths**
 - Core Paths
- Blocks**
 - Blocks
- Electricity Powerlines**
 - Overhead powerline
 - Underground powerline
- Scottish & Southern - Overhead Lines (Scot.)**
 - Overhead powerline
- Scottish & Southern - Underground Lines (Scot.)**
 - Underground powerline
- Water Pipelines**
 - Water Pipelines
- Communications**
 - Overhead telephone or fiberoptic
 - Underground telephone or fiberoptic
- Forest Roads (Classification)**
 - Class A
 - Class B
 - Class C
 - Restricted
 - Transfer Point
 - Unclassified
- Timber Transport Routes**
 - Agreed Route
 - Consultation Route
 - Restricted Route
 - Severely Restricted Route
 - Excluded Route
 - In Forest Haul Road
 - One Way Agreed Route
 - Permit Route
- Land Management Plan Areas**
 - Land Management Plan Areas

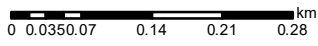
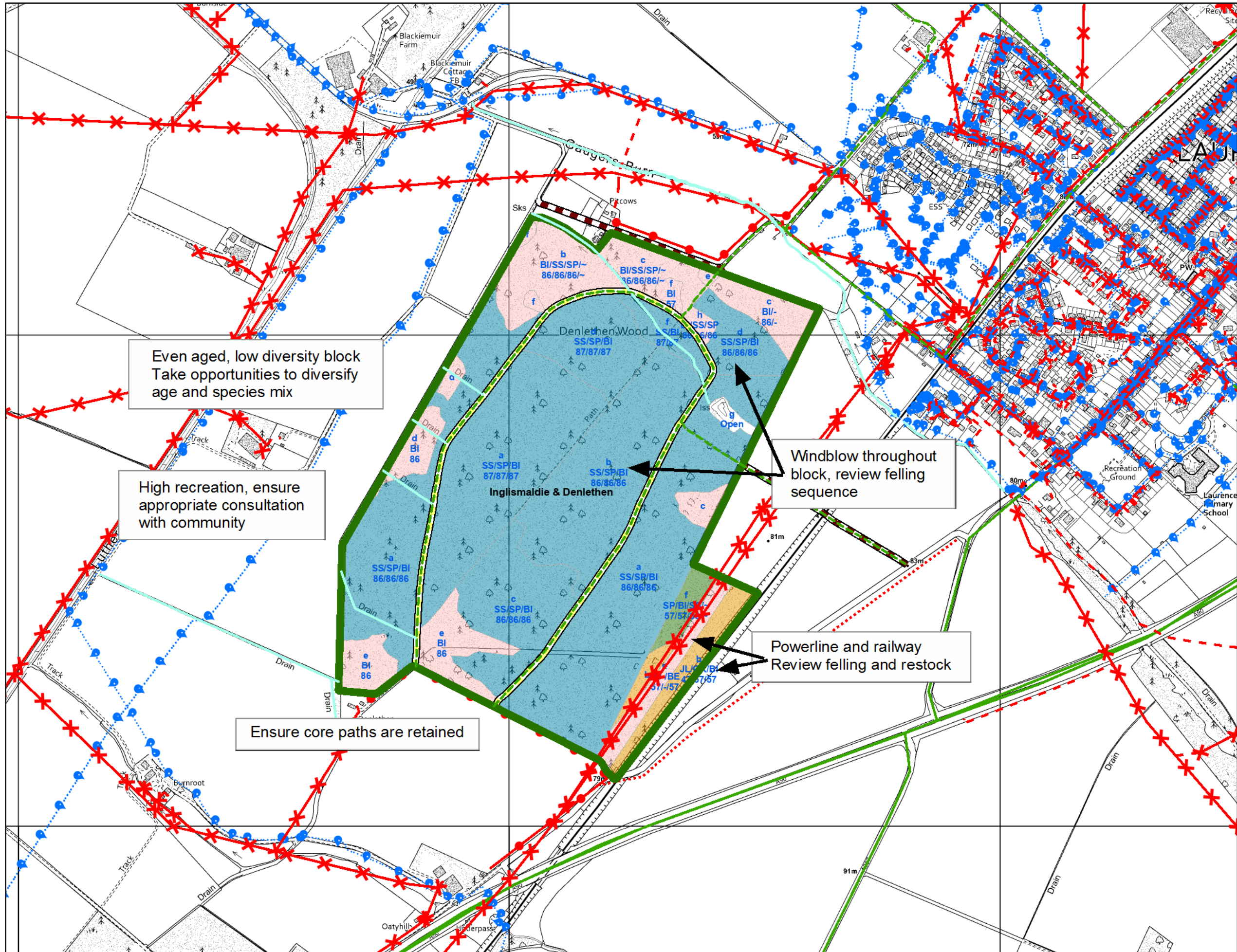

Reproduced by permission of Ordnance Survey on behalf of HMSO. © Crown copyright and database right 2024. All rights reserved. Ordnance Survey Licence number 100024925. © Getmapping Plc and Bluesky International Limited 2024.

Scotland's national forests and land are responsibly managed to the UK Woodland Assurance Standard.

